

GS BACK BARS

by asber 



Standard Features

HEAVY DUTY CONSTRUCTION

Top is made of solid 18" gauge stainless steel for easy cleaning. Wear resistant black vinyl exterior, and galvanized interior with durable stainless steel floor, and coved corners.

FIELD INTERCHANGEABLE DOORS

Solid to Glass and Glass to Solid based on operator's needs.

DUAL PANE THERMAL GLASS in "G" Models

Black aluminum frame, merchandise your product with greater visibility.

ENHANCED REFRIGERATION SYSTEM

Factory engineered oversized and balanced refrigeration system. CFC free R-134a refrigerators maintain temperature between 33°F to 38°F, keeping beers ice cold.

LEFT SIDE MOUNT COMPRESSOR & FRONT BREATHING

System allows easy service and unrestricted placement for the unit even in narrow spaces.

ANALOG THERMOSTAT

STAY OPEN DOORS WITH LOCKS AND LIGHT

90° Stay open door feature and fluorescent light underneath the mullion.

ADJUSTABLE, COATED WIRE SHELVES

Creating three levels to fit tall boy beers.

OPEN CAVITY

Evaporator located on left side above compressor providing open cavity and more working room.

MAGNETIC GASKET

Built of one piece, the gaskets are removable without tools for ease of cleaning and replacement.



GSBB-95



GSBB-69

Unit Options

Additional flat or bottle rail shelves / 3" Casters/
6" Adjustable stainless steel legs / 220v-50Hz-1Phase

Model	Doors	Capacity 12 oz. Can	Shlvs.	AMPS	HP	Voltage	NEMA Plug	Cord Length	Length	Width	Height	Weight
GSBB-59	2	852	4	6.6	1/3	115/60/1	5-15P	8'	59.5"	28"	37"	307
GSBB-69	2	1,014	4	6.6	1/3	115/60/1	5-15P	8'	69.5"	28"	37"	332
GSBB-79	3	1,092	6	6.9	1/3	115/60/1	5-15P	8'	80"	28"	37"	396
GSBB-95	3	1,302	6	7.2	1/3	115/60/1	5-15P	8'	95.5"	28"	37"	429

THE GROWLER STATION, INC.

19 Rancho Circle, Lake Forest, CA., 92630 ~ 949.387.5451 ~ www.growler-station.com

GS BACK BARS

by asber



ABBC-58(G) Front

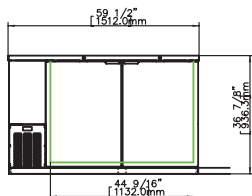

ABBC-68(G) Front

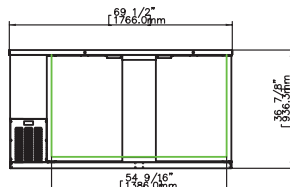

ABBC-78(G) Front

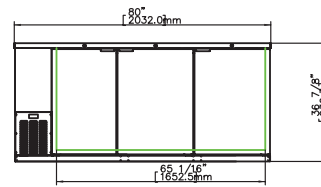

ABBC-58(G) Top

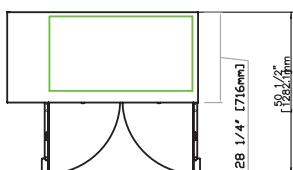

ABBC-68(G) Top

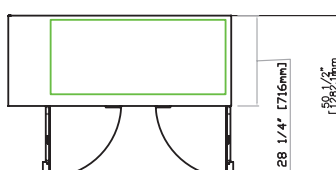

ABBC-78(G) Top

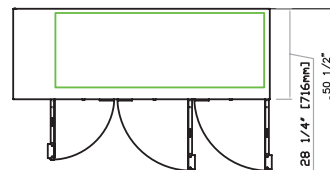

ABBC-94(G) Front

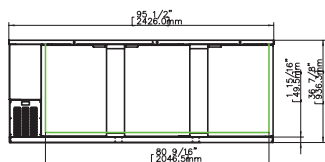

ABBC-94(G) Top

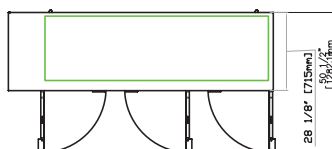

ABBC-Common View

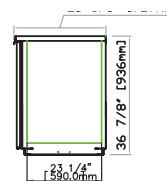

Specifications

Construction

Stainless steel 18 gauge top and stylish black vinyl finish front, sides and back. Interior built is galvanized steel walls with covered corner stainless steel floor. Interior Fluorescent light.

The entire cabinet has 1-1/2" CFC-free polyurethane insulation foamed in place

Refrigeration System

Oversized and balanced refrigeration system.

Self-contained capillary tube system using environmentally-friendly & CFC-free refrigerant. R-134a holding temperature at 33°F to 38°F.

Front breathing/side mounted compressor for ease of service and placement in narrow spaces. Condensing unit is behind the front grill, slides out for easy cleaning and maintenance.

Electrical

The whole unit is completely pre-wired at factory with cord and plug set included and ready for final connection to a 115/60/1 phase.

220V/50Hz/1ph available from factory.

Doors & Shelves

Field interchangeable doors from Solid to Glass and glass to solid. With 90° stay open feature, light and locks standard. One piece magnetic gasket for easy cleaning.

Dual pane glass doors in "G" models with black aluminum frame.

Adjustable, coated wire shelves, two per door, standard.

Forced air cooling system for faster cooling and constant temperature in the cabinet.

Large fan motor and fan blades for better air circulation.

Self contained system, no plumbing necessary.

Analog thermostat.

Warranty

Continental USA & Canada:

- One year labor and parts warranty.
- Five year compressor warranty.
- International: one year parts only.

THE GROWLER STATION, INC.

19 Rancho Circle, Lake Forest, CA., 92630 ~ 949.387.5451 ~ www.growler-station.com